

# E06

## D - SUB PCB STRAIGHT (STAMPED PIN)

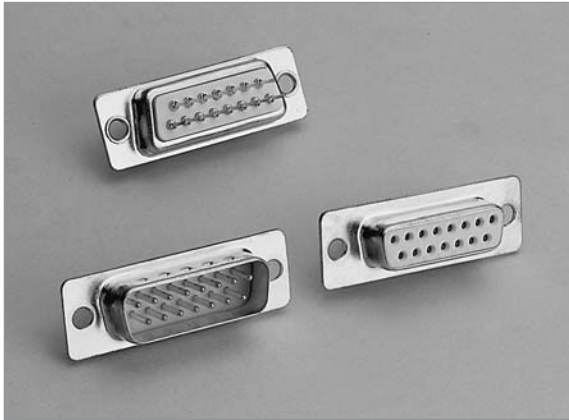

POSITION	A	B	C	D
9F	16.30	25.00	30.8	19.2
15F	24.60	33.30	39.2	27.7
19F	30.00	38.86	44.8	32.8
23F	35.30	44.30	50.3	38.3
25F	38.30	47.10	53.1	41.1
37F	54.80	63.50	69.4	57.3

POSITION	A	B	C	D
9M	16.92	25.00	30.8	19.2
15M	25.25	33.30	39.2	27.7
19M	30.60	38.86	44.8	32.8
23M	35.90	44.30	50.3	38.3
25M	38.96	47.10	53.1	41.1
37M	55.42	63.50	69.4	57.3

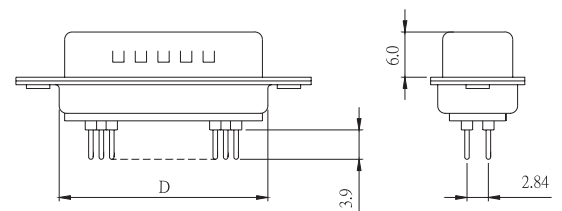
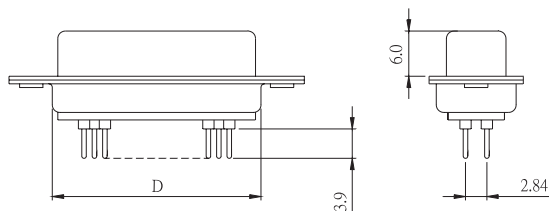
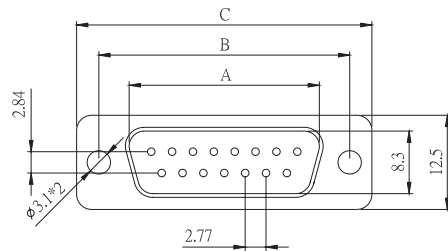
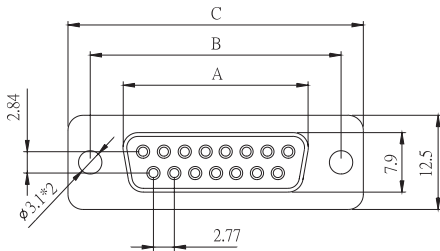

FEMALE

MALE

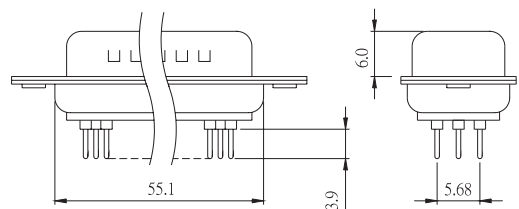
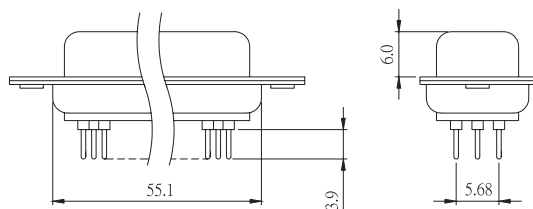
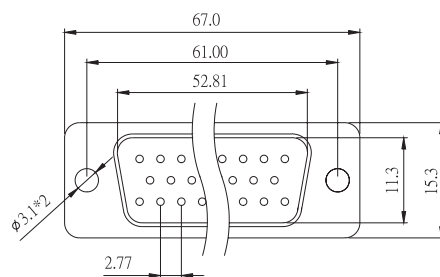
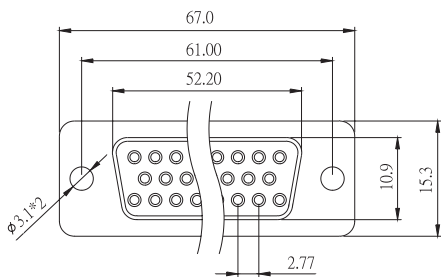

50 POSITION FEMALE

50 POSITION MALE

# E06

## D - SUB PCB STRAIGHT (STAMPED PIN)

### P.C.BOARD LAYOUT PATTERN

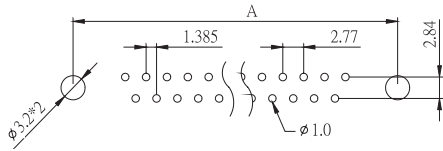

FEMALE / MALE

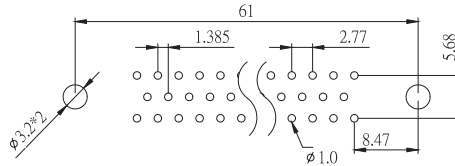

50 POSITION FEMALE / MALE

POSITION	A
9P	25.00
15P	33.30
19P	38.86
23P	44.30
25P	47.10
37P	63.50

### PROCESS OPTION

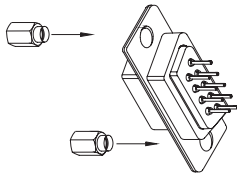

FRONT RIVET

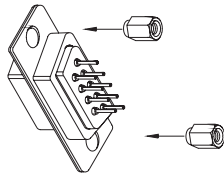

REAR RIVET

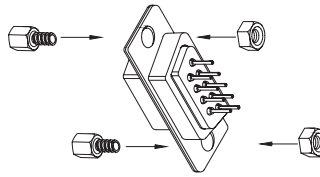

HEX SCREW + HEX NUT

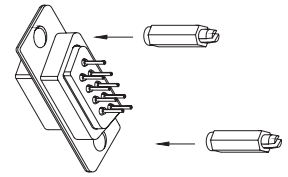

BOARDLOCK-NUT RIVET

### HOW TO ORDER:

E06 -  -  -  -  -  -  -

1.NO. OF CONTACT	2.CONTACT TYPE	3.CONTACT PLATING	4.SHELL PLATING
09 15 19 23 25 37 50	M: MALE A: MALE (HIGH PROFILE HOUSING) C: MALE (EMI TYPE) G: MALE (HIGH PROFILE HOUSING + EMI TYPE) F : FEMALE B: FEMALE (HIGH PROFILE HOUSING) D: FEMALE (EMI TYPE) H: FEMALE (HIGH PROFILE HOUSING + EMI TYPE)	T: TIN PLATED S: SELECTIVE G: GOLD FLASH A: 5u" INCH GOLD B: 10u" INCH GOLD C: 15u" INCH GOLD D: 30u" INCH GOLD	T: TIN N: NICKEL P: TIN + DIMPLE Q: NICKEL + DIMPLE Z: ZINC (CHROMATIC)
5.MOUNTING METHOD		6.ACCESSORIES	7.INSULATOR COLOR
A: THROUGH HOLE B: HEX SCREW + HEX NUT C: 3.8mm OPEN HEX RIVET D: 5.8mm OPEN HEX RIVET E: 4.8mm CLOSE HEX RIVET F: 5.8mm CLOSE HEX RIVET G: 5.8mm CLOSE ROUND RIVET H: 7.1mm ROUND THREAD RIVET		A: NON ACCESSORIES B: FRONT RIVET C: FRONT RIVET ADD SCREW D: FRONT RIVET FIX SCREW E: REAR RIVET F: REAR RIVET ADD SCREW G: REAR RIVET FIX SCREW	1. BLACK 2. GREY 3. BLUE 5. WHITE
I: 5.8mm BOARDLOCK RIVET J: 10mm BOARDLOCK RIVET K: 2.5mm OPEN HEX RIVET			